

Order N° \_\_\_\_\_  Quotation  
 Date \_\_\_\_\_ Signature \_\_\_\_\_  
 Customer Ref. \_\_\_\_\_

PAG. 1/2  
 Jan 2022



Dealer

**Key**

standard

option

**HALLEY**

- L** Seat width 34 36 38 40 42 44
- P** Seat depth 36 38 40 42 44
- HS** Back-rest height 29 31 33 35 37 39 41
- HA** Front seat/floor height 46 48 50
- HP** Rear seat/floor height 40 42 44 46
- DP** Foot-rest/seat distance 35 37 39 41 43 45 47

cm

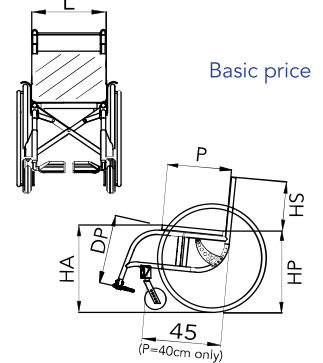

Basic price

**Frame colour**

- Glossy black  Pearl red  Matte black  
 Pearl white  Metallic blue  Metallic grey  
 ..... (see "Colours" catalogue)  
 Neon orange  Neon green

①

**Upholstery**

- Tension adjustable nylon back-rest  
 Tens.adjustable breathable backrest  
 Without backrest  
 **FAMEKH** custom postural backrest  
(fill up the proper order form)

②

**Upholstery colour**

- (nylon only)
- Black  
 Red  Orange  
 Light blue  Green  
 Cornflower blue

③

- Not detachable foot-rest** ④  
 (with DP=43 cm and P=40 cm)  
 (standard)

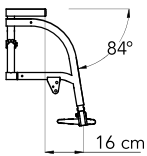

- Not detachable foot-rest**  
 (with DP=43 cm and P=40 cm)

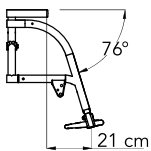

- Detachable foot-rest**

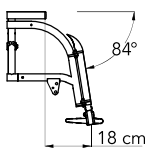

(approx. measurement)

- Closed carbon single foot-plate** ⑥

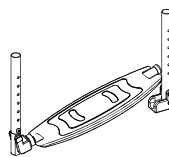

- Foot-holding belts

**Separate aluminium profile tilt adjustable foot-plates** ⑧

- forward  backward

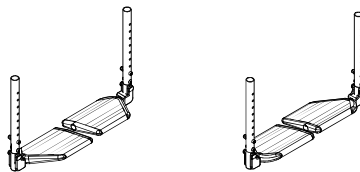

- Foot-holding belts

- Automatic closure foot-plate in carbon** ⑦

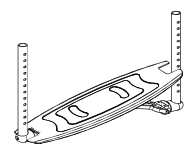

- Foot-holding belts

**Single aluminium profile tilt adjustable foot-plate** ⑨

- forward  backward

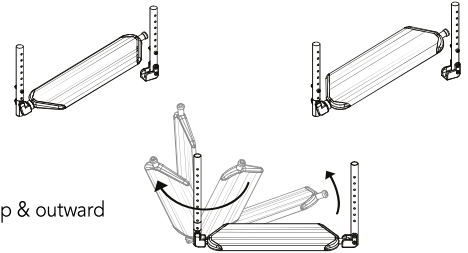

- up & outward

- Foot-holding belts

**Side guards** ⑩

- Carbon fibre



- Aluminium



- Detachable sport arm-rest h. 22 cm** ⑪

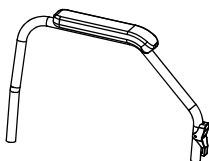

- Tip-up

**Elbow-rest**

- Tubular  
 Classic (23 cm long)  
 Classic (30 cm long)

- Tip-up height adjustable from 22 to 28 cm "L" arm-rest** ⑫  
 (open with sideguards)

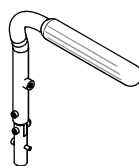

**Elbow-rest**

- Tubular  
 Straight (26 cm long)  
 Classic (23 cm long)  
 Classic (30 cm long)

**Rear wheels** ⑬

- 24" Star 6x3 (18 spokes)  
 24" (36 spokes)  
 24" Light(24 spokes)  
 24" MTB with Citybike tyre  
 24" MTB with Offroad tyre  
 24" Spinergy  
 24" Ultralight(24 spokes)

**Tyres**

- Pneumatic Marathon Plus  
 Pneum. high press. plugged  
 Pneum. high press. smooth  
 Solid (not avail. with Ultralight)

- Aluminium silver  
 Aluminium dark  
 Chromium-plated steel 24"  
 Rubber coated  
 Titanium  
 Carbolife CURVE L24\*\*  
 CL Curve L TetraGrip 24\*\*  
 CL Quadro rubber ctd 24\*\*  
 Carbolife GEKKO 24\*\*  
 Silicon covers

\* not suitable for wheels Star 6x3 and Mountain Bike

